

DIN 980 similar to ISO 7042

Hexagon nuts

With clamping part | all metal | form V: one-piece

Steel 8 | zinc-plated | Cr(VI)-free | Metric fine thread

Further information: DIN standard has been withdrawn | modified nut height and wrench width

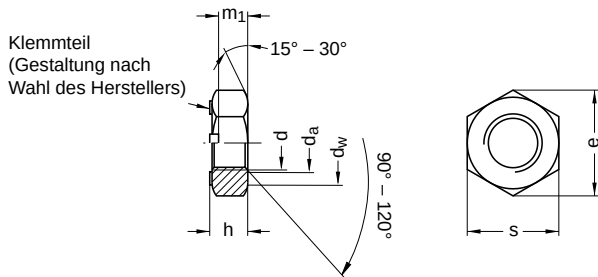

Diameter (d)	d _a		d _w	h		m ₁	e	s		Pitch (P)	Tool size
	min.	max.		min.	max.			min.	max.		
M10 x 1	10	10.8	15.6	9	10	5.5	18.90	16.73	17	1.00	SW 17
M10 x 1.25	10	10.8	15.6	9	10	5.5	18.90	16.73	17	1.25	SW 17
M12 x 1.5	12	13.0	17.4	11	12	6.6	21.10	18.67	19	1.50	SW 19
M14 x 1.5	14	15.1	20.5	12	14	7.7	24.49	21.67	22	1.50	SW 22
M16 x 1.5	16	17.3	22.5	14	16	8.8	26.75	23.67	24	1.50	SW 24
M20 x 1.5	20	21.6	27.7	18	20	11.0	32.95	29.16	30	1.50	SW 30
M20 x 2	20	21.6	27.7	18	20	11.0	32.95	29.16	30	2.00	SW 30
M24 x 1.5	24	25.9	33.2	22	24	13.2	39.55	35.00	36	1.50	SW 36
M24 x 2	24	25.9	33.2	22	24	13.2	39.55	35.00	36	2.00	SW 36
M30 x 2	30	32.4	42.7	28	30	16.5	50.85	45.00	46	2.00	SW 46

All technical data refer to the measure mm

