

**DIN 1476** similar to ISO 8746

# Round head grooved pins

Round head

Stainless steel A2 | Cr(VI)-free

Further information: DIN standard has been withdrawn

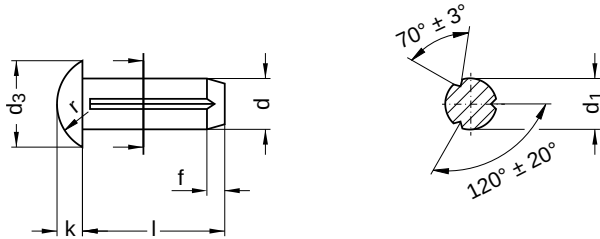

Diameter (d)	d <sub>1</sub>		d <sub>3</sub>			f	k			r
	min.	max.	nominal size	min.	max.		nominal size	min.	max.	
1.4	1.35	1.4	2.4	2.20	2.60	0.5	0.8	0.70	0.90	1.4
1.6	1.55	1.6	2.8	2.60	3.00	0.5	1.0	0.90	1.10	1.6
2	1.95	2.0	3.5	3.30	3.70	0.5	1.2	1.10	1.30	1.9
2.5	2.42	2.5	4.4	4.20	4.60	0.7	1.5	1.40	1.60	2.4
3	2.92	3.0	5.2	4.95	5.45	1.0	1.8	1.65	1.95	2.8
4	3.90	4.0	7	6.75	7.25	1.5	2.4	2.25	2.55	3.8
5	4.90	5.0	8.8	8.50	9.10	1.5	3.0	2.85	3.15	4.6

nominal size	Length (l)	
	min.	max.
3	2.76	3.24
4	3.76	4.24
5	4.76	5.24
6	5.76	6.24
8	7.71	8.29
10	9.71	10.29

nominal size	Length (l)	
	min.	max.
12	11.65	12.35
16	15.65	16.35

Diameter (d)	Length (l)							
	3	4	5	6	8	10	12	16
1.4	●	●	●	●				
1.6	●	●	●	●				
2	●	●	●	●	●	●		
2.5	●	●	●	●	●	●	●	
3	●	●	●	●	●	●	●	
4			●	●	●	●	●	
5				●	●	●	●	

• Combinations available in the eShop | Other sizes on request

All technical data refer to the measure mm

