

B 50500 similar to ISO 7380

Safety screws

Button head | hexagon socket drive with dog point

Stainless steel A2 | Cr(VI)-free | Metric thread

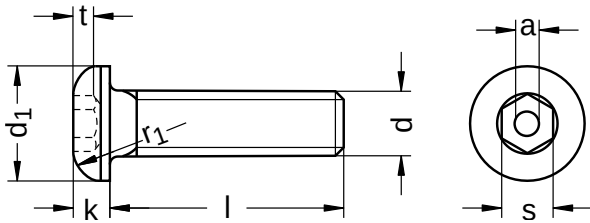

Diameter (d)	a		nominal size	d ₁		nominal size	k	
	min.	max.		min.	max.		min.	max.
M4	0.9	1.1	7.6	7.24	7.6	2.20	1.95	2.20
M5	1.1	1.3	9.5	9.14	9.5	2.75	2.50	2.75
M6	1.4	1.6	10.5	10.07	10.5	3.30	3.00	3.30
M8	1.8	2.0	14	13.57	14.0	4.40	4.10	4.40
M12	-	-	-	-	-	-	-	-

Diameter (d)	r ₁	s		Pitch (P)	t	Tool size	
	nominal size	nominal size	min.				max.
M4	4.1	2.5	2.52	2.58	0.70	1.30	SW 2,5
M5	5.2	3.0	3.02	3.08	0.80	1.56	SW 3
M6	5.6	4.0	4.02	4.10	1.00	2.08	SW 4
M8	7.5	5.0	5.02	5.14	1.25	2.60	SW 5
M12	-	-	-	-	1.75	-	-

Length (l) nominal size
10
12
16
20
25
30

Length (l) nominal size
35
40
45
50

All technical data refer to the measure mm



B 50500 similar to ISO 7380

Safety screws

Button head | hexagon socket drive with dog point

Stainless steel A2 | Cr(VI)-free | Metric thread

Diameter (d)	Length (l)									
	10	12	16	20	25	30	35	40	45	50
M4	●	●	●	●	●	●				
M5	●	●	●	●	●	●				
M6	●	●	●	●	●	●	●	●	●	●
M8	●	●	●	●	●	●	●	●	●	●
M12					●					

- Combinations available in the eShop | Other sizes on request

All technical data refer to the measure mm

