

B 315

Wing nuts

Angular wing shape (American form)

Stainless steel A4 | Cr(VI)-free | Metric thread

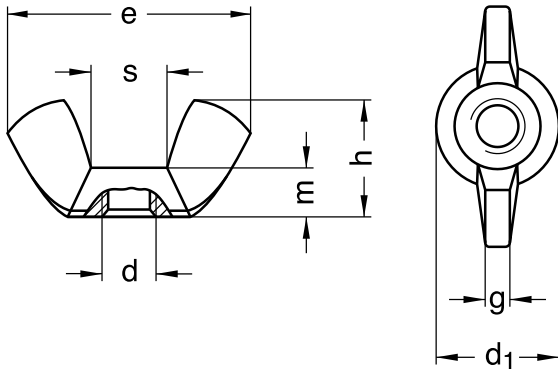

Diameter (d)	d ₁		g		e		h		m		s nominal size	Pitch (P)
	min.	max.	max.	min.	max.	min.	min.	max.	min.	max.		
M3	6.7	8.3	2.9	1.9	20.00	16.50	7.60	9.60	2.60	3.6	4.8	0.50
M4	6.7	8.3	2.9	1.9	20.00	16.50	7.60	9.60	2.60	3.6	4.8	0.70
M5	8.7	10.3	3.1	2.1	23.50	20.50	9.50	11.50	3.50	4.5	6.2	0.80
M6	11.1	12.7	3.5	2.5	28.70	25.70	11.70	13.70	4.30	5.5	8.8	1.00
M8	12.6	14.4	3.8	2.8	32.00	28.60	13.60	16.00	4.80	6.0	9.1	1.25
M10	14.4	16.2	4.5	3.5	38.00	33.60	16.00	18.00	5.78	6.9	11.0	1.50
M12	19.5	21.5	5.5	4.5	50.00	45.00	21.00	24.00	7.30	8.5	14.4	1.75
M14	24.6	26.4	7.5	6.1	65.75	62.25	29.05	32.55	10.00	11.2	17.5	2.00
M16	24.6	26.4	7.5	6.1	65.75	62.25	29.05	32.55	10.00	11.2	17.5	2.00

All technical data refer to the measure mm

